

ATW 3043 CROWN
WALL COVERAGE

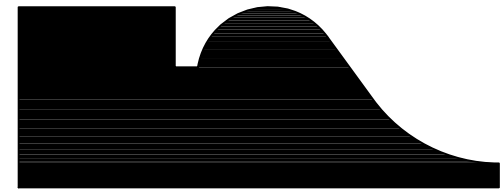
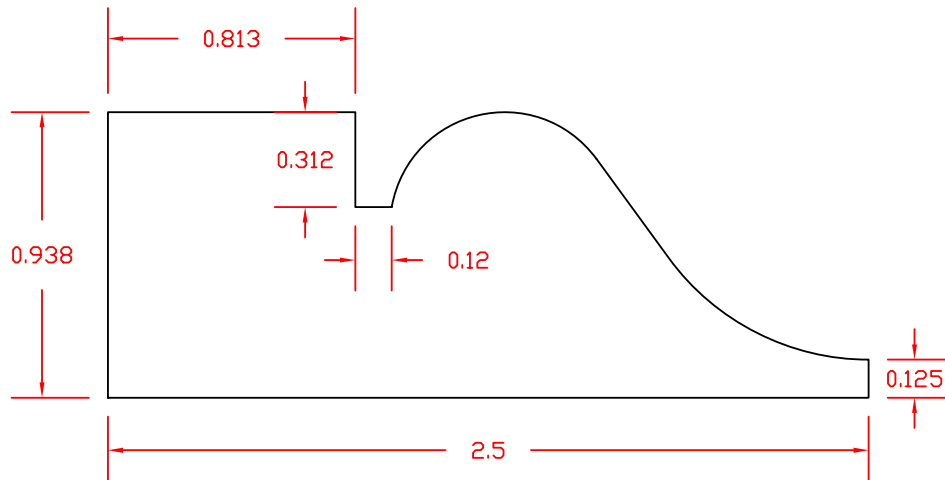
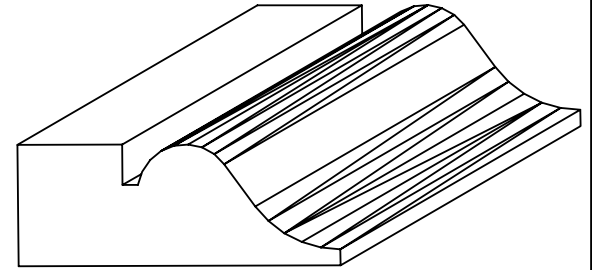
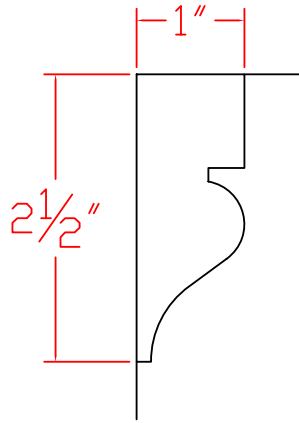

2-1/2" CROWN MOULDING
ATW-3043

Advanced TrimWright, Inc.™ The New Standard of Exterior Trim Products 250 Cape Highway East Taunton, MA 02718 Phone: 508-822-7745 Fax: 508-822-7734 Website: www.advancedtrimwright.com © 2005 AdvancedTrimWright, Inc.					SCALE	DATE	DESIGNED BY	CHECKED BY	APPROVED
					2:1	1/4/07	JJM		X
					PROFILE TYPE: CROWN MOULDING				
					SIZE: 1' X 2-1/2'				
					LOCATION: S:\CADD\OFFICE\MOULDINGS\3043				
					ATW-3043				
					BROSCO REF. # 8047				